

# ADA66 & ASA66 Electronic Side Load Locks



ADA66 Double Action



ASA66 Single Action

***The motor driven Electronic Side Load Lock is available for single or double acting doors in both commercial and residential areas of a building.***

The lock addresses the two biggest issues in door locking, the ability to align a misaligned door and the ability to release when requested, even with excessive load on the bolts. The electronic lock is reliable, secure and convenient.

The side door lock can convert from Fail Safe to Fail Secure by repositioning a single jumper. The door can have in excess of 1000kg being applied and it will still release instantly when requested.

| Stock Code |                                 |
|------------|---------------------------------|
| ADA66      | Double Action Motor Driven Lock |
| SIN-ADA66  | Intumescent kit to suit ADA66   |
| ASA66      | Single Action Motor Driven Lock |
| SIN-ASA66  | Intumescent kit to suit ASA66   |

## Features & Benefits

- Door misalignment of up to  $\pm 8$ mm is corrected
- Automatic Dead-bolting
- Two, 10mm thick stainless bolt pins
- Reverse polarity and transient protection
- Multiple attempts to lock
- Door and bolt position monitors
- Mortice mount horizontally or vertically, on double or single acting doors
- Surface mount with the aid of the accessories, including mounting onto glass

## Certification

- EN61000-6-1: 2007
- EN61000-6-3: 2007 + Amendment 1: 2001
- FCC Part 15, subparts A and B
- Patent pending: PCT/IB2013/053737
- Fire test in accordance BS 476:Part 22-1987 for 30 & 60min timber doors

# ADA66 & ASA66 Electronic Side Load Locks

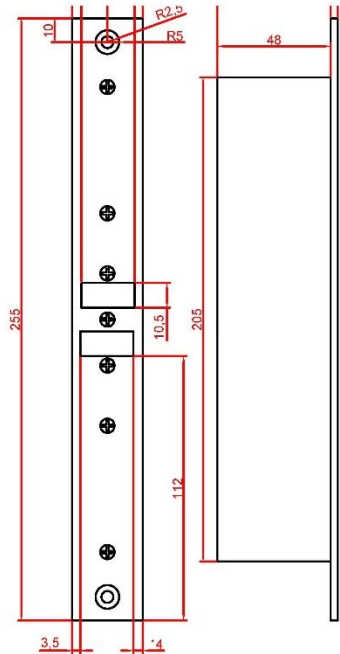

ADA66

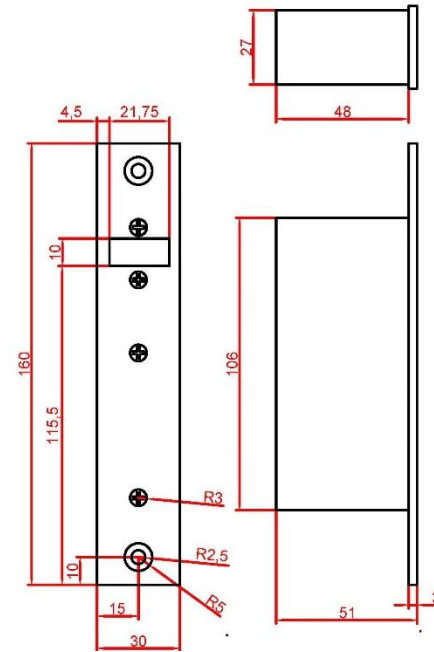
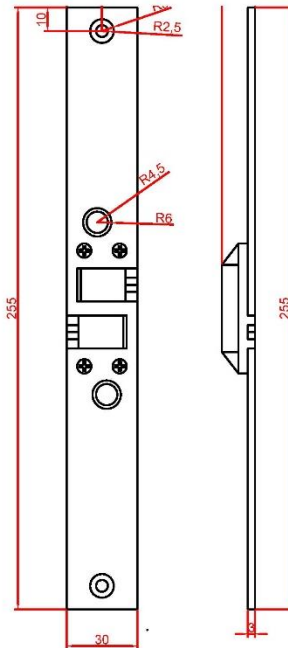

ASA66

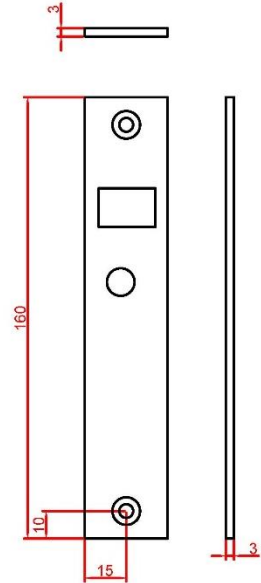

## Technical Information

|                 |  |
|-----------------|--|
| Holding Force   | 10,000N (1020kgf / 2,250lbf)   |
| Input Voltage   | 12V DC – 24V DC  |
| Current Draw    | @12V 1800mA to lock and unlock<br>@24V 600mA to lock and unlock                            |
| Standby Current | 50mA   |
| Dimensions      | <b>Single Lock</b> - H160mm x W30mm x D51mm<br><b>Double Lock</b> - H255mm x W30mm x D51mm |